



KRYTAC®

OWNER'S MANUAL

TRIDENT

LMG-M | LMG-MP

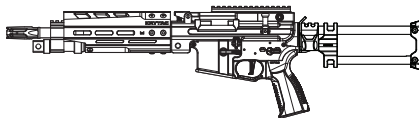
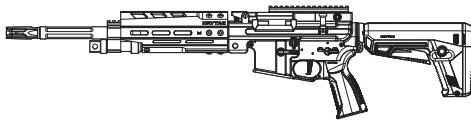

TABLE OF CONTENTS

Safety Rules	2
Specifications	4
Electronic Control Unit	6
Velocity and Energy Output Chart	7
Package Contents	7
Using the Box Magazine.....	8
Fire Selector Switch.....	10
Stock Adjustment.....	10
Battery Installation	11
Trigger Pull Adjustment	12
Hop-Up System	13
Clearing Jammed BBs.....	14
Disassembly	15
Assembly.....	15
Main Spring Access.....	16
Cleaning and Maintenance.....	19
Trouble Shooting Guide.....	21
Operating Under Harsh Conditions	22
Hearing Protection Requirement	22
Contact Information	22
Component Diagrams and Lists	23



WARNING

THIS PRODUCT IS NOT INTENDED FOR USE BY UNTRAINED PERSONS (INCLUDING CHILDREN) WITH OR WITHOUT PHYSICAL OR MENTAL HANDICAPS. THESE HANDICAPS INCLUDE REDUCED PHYSICAL, SENSORY OR MENTAL CAPABILITIES, OR LACK OF EXPERIENCE AND KNOWLEDGE OF THE PRODUCT AND SAFETY GUIDELINES. ALL USERS SHOULD HAVE TRAINED SUPERVISION OR INSTRUCTIONS CONCERNING THE USE OF THE APPLIANCE BY A PERSON RESPONSIBLE FOR HIS OR HER SAFETY.

SAFETY RULES

Please read the entire KRYTAC manual before operating the airsoft electric gun (AEG). This manual covers important safety, operational, and maintenance topics. It is important that the user reads and understands the manual in order to safely handle and operate the airsoft electric gun (AEG). Failure to follow the safety guidelines and/or operational instructions in this manual may result in serious personal injury or damage to the airsoft electric gun (AEG).

Safety Guidelines

EYE PROTECTION

Always wear eye protection while shooting, operating, and maintaining your airsoft guns.

FIREARM SAFETY RULES

Always assume that the airsoft gun is loaded. Never assume the chamber is empty based on memory or from someone else's word. An airsoft gun can still fire with the magazine removed.

KEEP YOUR FINGER OFF THE TRIGGER

Remove your finger from the inside of the trigger guard until your sights are aligned on target and you are ready to fire.

MUZZLE CONTROL

Always keep the muzzle of the airsoft gun pointed in a safe direction. Never point the airsoft gun towards anything you do not intend to shoot.

KNOW YOUR TARGET AND ITS SURROUNDINGS (SAFETY DISTANCE)

Take note of objects in front of and beyond your target. Airsoft guns can shoot up to and beyond 150 feet/45 meter and may travel further than intended without an adequate backstop. Never shoot an airsoft gun directly at targets such as rocks, glass, water, or other hard surfaces that may ricochet BBs in unpredictable directions.



WARNING

SAFETY IS YOUR RESPONSIBILITY

The KRYTAC airsoft gun is designed and manufactured to KRYTAC's high standards. It was carefully inspected before it was packaged and shipped from our factory. It is the sole responsibility of the user for its safe use and handling. This airsoft gun is safe unless handled irresponsibly or misused.

BEWARE OF BARREL OBSTRUCTIONS

Ensure that the barrel of your airsoft gun is free and clear of any obstructions prior to firing the airsoft gun. Failure to do so may cause a malfunction, and in some cases damage the airsoft gun.

KEEP THE SAFETY ON

Keep the fire selector set to safe until your sights are aligned on target and you are ready to fire.

SAFETY RULES

FAILURE TO FIRE

If the airsoft gun fails to fire, misfires, or malfunctions, do not look into/down the barrel of the airsoft gun. BBs can jam in the chamber and can launch suddenly while under pressure causing serious injury.

FUSE

DO NOT REMOVE OR BYPASS THE FUSE. It is an integral part of the system. Alterations to the fuse will void warranty and may result in operational failure and critical damage to internal components.

MAINTAIN YOUR AIRSOFT GUN PROPERLY

Maintaining your airsoft gun as outlined in the manual ensures that your airsoft gun will be safe to shoot and perform to its designed specifications. Alterations, modifications, or adjustments may damage your airsoft gun, making it unsafe to shoot and/or voiding all warranty claims.

STORAGE AND TRANSPORT

Keep the fire selector on the airsoft gun set to safe, with the magazine and battery removed when storing your airsoft gun. Always store your airsoft gun in a safe place and out of the reach of children. When transporting your airsoft gun make sure that it is in a designated airsoft gun case. Never brandish your airsoft gun in public.



WARNING

IT IS YOUR RESPONSIBILITY TO SAFELY STORE AND TRANSPORT YOUR AIRSOFT GUN.

ORANGE TIP

Any alteration of the coloration or markings required by state and/or federal law may be deemed illegal in a court of law. All risks and responsibility of any alteration to the product will be assumed by the operators, owners and/or user of the product.



WARNING

THE ORANGE TIP DOES NOT DISTINGUISH YOUR AIRSOFT GUN AS A TOY, ALWAYS TREAT YOUR AIRSOFT GUN AS IF IT IS A REAL FIREARM.

HAZARDS OF BEING MISTAKEN FOR A REAL FIREARM

Due to the nature and design of some airsoft guns, they may be mistaken as a real firearm. It is strongly advised to operate an airsoft gun in the safety and privacy of your own home, or at a legally sanctioned location or game field. Police, Peace Officers, and Law Enforcement Officers are trained to treat objects that resemble a firearm as one. In the event that you are approached by a Law Enforcement Official, completely comply with their instructions. Never point an airsoft gun at a Law Enforcement Official. Confrontation with a Law Enforcement Official may result in serious injury or death.

ALCOHOL, MEDICATIONS AND DRUGS

Do not handle or operate your airsoft gun while under the influence of alcohol, medication, or drugs that may impair judgment.

SPECIFICATIONS

TRIDENT LMG-M

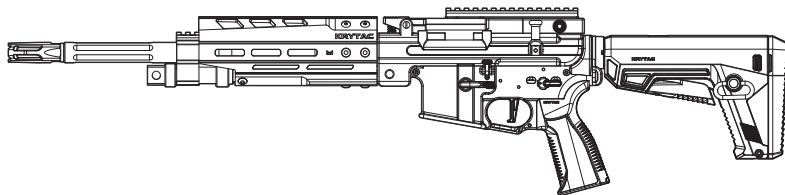

Caliber	6mm
Overall Length	859mm (33.8") - 944mm (37.2")
Overall Height	206mm (8.1")
Weight	3.8kg (8.4 lbs)
Outer Barrel Length	406.4mm (16")
Inner Barrel Length	416 mm
Inner Barrel Diameter	6.03 mm
Rate of Fire	21+ RPS

PERFORMANCE DETAILS ARE BASED ON U.S. SPECIFICATIONS AND CAN BE MODIFIED TO MEET THE LAWS AND REGULATIONS OF YOUR LOCAL REGION.

PRODUCT FEATURES

KRYTAC metal alloy receiver

KRYTAC LMG enhanced M-LOK rail system

KRYTAC angled motor grip

KRYTAC low profile battery stock

Ambidextrous fire selector

Licensed CMC adjustable trigger

MIL-STD 1913 Picatinny top rail

KRYTAC Nautilus mechbox with 8mm bearings, Gate Titan-ready

Electronic Control Unit (ECU)

Microswitch E-trigger

Easy spring access

Padded cylinder head

Relief-cut cylinder window

Anti-corrosion mechbox coating

Lightweight, full metal rack piston

Improved rotary hop-up with temperature and wear-resistant hop-up bucking

KRYTAC neo high torque motor

SPECIFICATIONS

TRIDENT LMG-MP

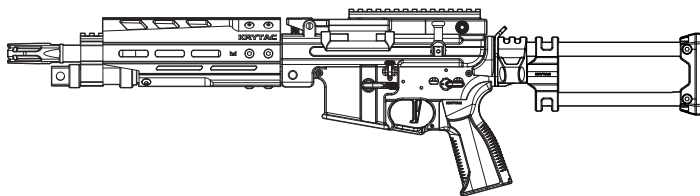

Caliber	6mm
Overall Length	634mm (25") - 769mm (30.3")
Overall Height	206mm (8.1")
Weight	3.73kg (8.2 lbs)
Outer Barrel Length	228.6 mm (9")
Inner Barrel Length	310 mm
Inner Barrel Diameter	6.03 mm
Rate of Fire	21+ RPS

PERFORMANCE DETAILS ARE BASED ON U.S. SPECIFICATIONS AND CAN BE MODIFIED TO MEET THE LAWS AND REGULATIONS OF YOUR LOCAL REGION.

PRODUCT FEATURES

KRYTAC metal alloy receiver	Electronic Control Unit (ECU)
KRYTAC LMG enhanced M-LOK rail system	Microswitch E-trigger
KRYTAC angled motor grip	Easy spring access
KRYTAC para stock	Padded cylinder head
Ambidextrous fire selector	Relief-cut cylinder window
Licensed CMC adjustable trigger	Anti-corrosion mechbox coating
MIL-STD 1913 Picatinny top rail	Lightweight, full metal rack piston
KRYTAC Nautilus mechbox with 8mm bearings, Gate Titan-ready	Improved rotary hop-up with temperature and wear-resistant hop-up bucking
	KRYTAC neo high-torque motor

ELECTRONIC CONTROL UNIT (ECU)

The ECU features new functionality and protection for your KRYTAC airsoft gun.

FULL CYCLE DETECTION AND PARTIAL ACTIVE BREAKING

Full cycle detection and partial active braking ensure the gearbox completes its cycle without interruption, preventing motor inertia from causing double firing in semi-auto mode and reducing the risk of rapid overheating.

BATTERY AND POWER DETECTION

When connecting a 7.4v battery: The motor will emit two beeps upon detecting a connection. When the battery level is low, the motor will emit a short beep every half second while the trigger is active.

When connecting a 11.1v battery: The motor will emit three beeps upon detecting a connection. When the battery level is low, the motor will emit a short beep every half second while the trigger is active.

Battery Type	Battery Connection	Battery Low Power Detection
7.4v 2 cell lipo battery	2 beeps on connection	1 short beep every 0.5 seconds
11.1v 3 cell lipo battery	3 beeps on connection	1 short beep every 0.5 seconds



WARNING

HIGH VOLTAGE BATTERY: WHEN THE BATTERY CONNECTED IS HIGHER THAN RECOMMENDED USABLE VOLTAGE, THE MOTOR WILL EMIT A SINGLE CONTINUOUS BEEP AND THE MOTOR WILL NOT ENGAGE.

GEAR PROTECTION AUTO POWER-OFF

When the trigger is held down for two seconds and no gear movement is detected, the power is cut off. This feature is designed to prevent further or more significant harm in case of mechanical malfunctions that could occur by continuing to press the trigger.

ECU SLEEP MODE

When the selector switch is turned to the safety position, the electronic control unit will enter sleep mode to lower power consumption, reducing parasitic discharge and prolonging battery life

VELOCITY AND ENERGY OUTPUT CHART

Your KRYTAC product has been configured to comply with your region's energy output regulations. The table below is a reference to the energy output specifications organized by region.

Country	Max Velocity	Energy Output
Japan, Italy	85 m/s	0.73 Joules
UK	110 m/s	1.24 Joules
Argentina, Austria, Belgium, Bosnia, Brazil, Bulgaria, Canada, Chile, Croatia, Cyprus, Czech Republic, Denmark, Estonia, Finland, France, Germany, Greece, Guatemala, Herzegovina, Hong Kong, Hungary, Iceland, Israel, Latvia, Liechtenstein, Lithuania, Macedonia, Moldavia, Netherlands, New Zealand, Norway, Paraguay, Philippines, Poland, Portugal, Romania, Russia, Serbia, Slovakia, Slovenia, South Africa, South Korea, Spain, Sweden, Switzerland, Turkey, U.S.A.	120 m/s	1.45 Joules

PACKAGE CONTENTS

- [1] TRIDENT LMG-M / LMG-MP airsoft electric gun (AEG)
- [1] Auto-winding 5,000rd box magazine
- [1] Set of low-profile front and rear sights
- [1] Short M-LOK rail section
- [1] User's manual
- [1] Cleaning rod

USING THE BOX MAGAZINE

Attaching Battery to the Box Magazine

1. Lift the locking tab **(A)** up and over to remove the side panel **(B)**.

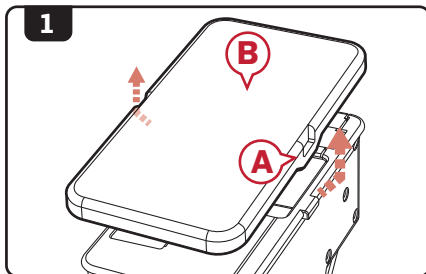

2. Connect a mini / brick-type 7.4v lithium battery pack **(C)** with T-Plug connector and place it into the battery cavity **(D)**.

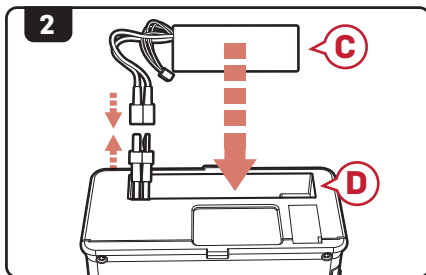

NOTE: To prevent damage and reduce wear on internal components, avoid using a battery with a voltage higher than 7.4V with the KRYTAC box mag.

3. Replace the side panel by placing the front locking tab **(E)** on first then secure with the last locking tab **(F)**.

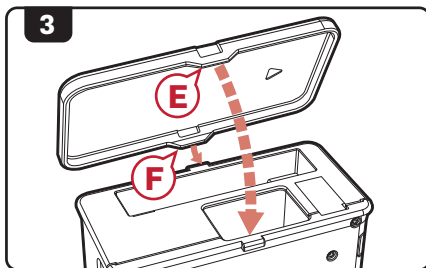

WARNING

DISCONNECT THE BATTERY WHEN THE MAGAZINE IS NOT IN USE

Loading the Box Magazine

1. Follow the previous instructions to remove the side panel.

2. Pour BBs into the internal reservoir **(A)**. Capacity is approximately 5,000 BBs. Then, reinstall the side panel.

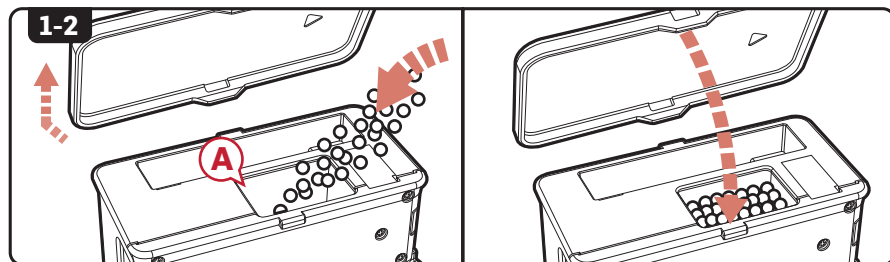

USING THE BOX MAGAZINE

Loading the Box Magazine

3. Switch the power switch **(B)** on, then press and hold the winding button **(C)** for 5 seconds to prime the magazine.

NOTE: Box magazine will periodically wind itself while in use.

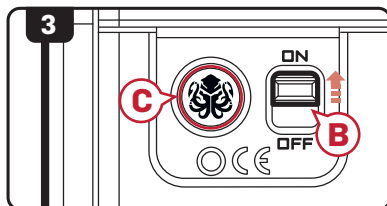

Storing the Box Magazine

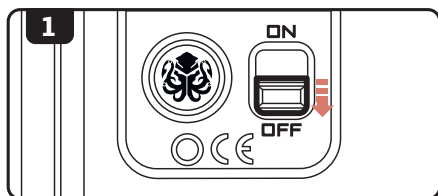

CAUTION: ALWAYS UNLOAD MAGAZINE PRIOR TO STORAGE TO PRESERVE SPRING LIFE.

1. Turn the power switch off **(A)**.
2. Have an appropriate container ready to catch BBs and pull back on the retention tab **(B)** on the top of the magazine.
3. Open the side panel and unplug the battery pack **(C)**.

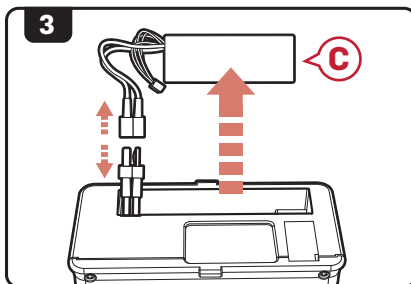
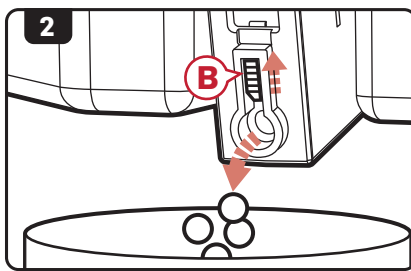

Troubleshooting: If no BBs are feeding from the box magazine

1. No noise from the box magazine motor.
 - a. Check to see that the battery is properly connected.
 - b. Check to ensure that the battery still has power. If not replace the battery.
2. Makes a noise but does not seem to feed.
 - a. Press the winding button on the bottom of the magazine again to add more tension to the follower.
 - b. Ensure that there are BBs in the reservoir. If not, open the side panel and fill the reservoir with BBs.
 - c. The magazine may have an obstruction and will require servicing.

FIRE SELECTOR SWITCH

NOTE

It is advised when you are not ready to fire, keep the fire selector switch on the airsoft gun in the safe position.



WARNING

DO NOT ENGAGE THE TRIGGER WHILE SWITCHING BETWEEN MODES ON THE FIRE SELECTOR.

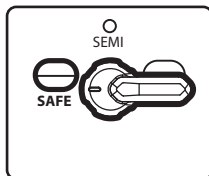

SAFE MODE

When in safe mode, the trigger will not engage and the airsoft gun will not fire.

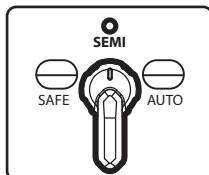

SEMI-AUTO MODE

While in semi-auto mode, the airsoft gun will only fire one shot for each time the trigger is engaged.

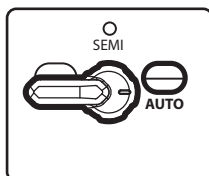

FULL-AUTO MODE

In full-auto mode, the gun will continuously fire as long as the trigger remains engaged.

STOCK ADJUSTMENT

KRYTAC LOW PROFILE STOCK

1. Press the stock adjustment latch (A) to slide the stock into the desired position.

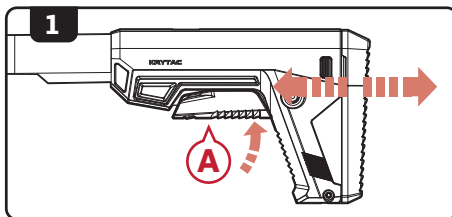

KRYTAC PARA STOCK

1. Pull the stock (A) to the rear and twist clockwise to align the stock with the open slot (B) to lock into position.

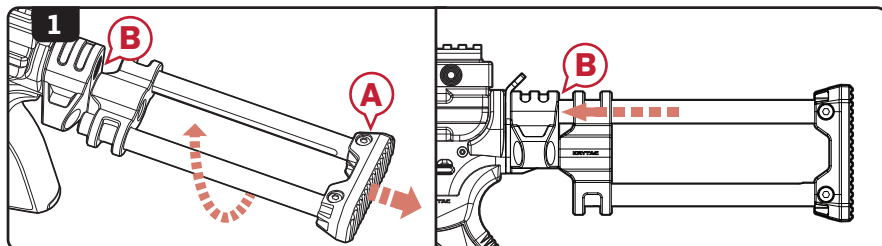

BATTERY INSTALLATION

LMG-M



WARNING

ENSURE THAT THE STOCK IS IN THE FULLY COLLAPSED POSITION BEFORE OPENING THE STOCK COVER. DO NOT REMOVE THE STOCK COMPLETELY FROM THE GUN.

1. Set the fire selector to Safe. Collapse the stock to its shortest position. Press the stock cover release latch **(A)** on both sides of the stock and pivot the cover downward. **CAUTION:** Do not force the cover beyond its fully open position.

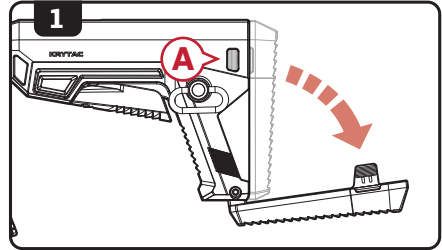

- 2A. Insert a 7.4v / 11.1v stick-type or nunchuk-type lithium battery pack into the center tube **(B)**. Push the battery connectors **(C)** together until completely mated.

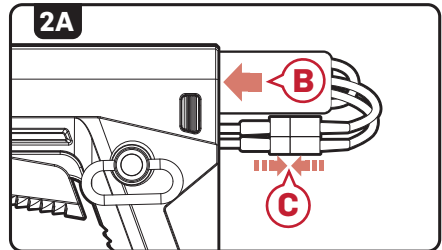

- 2B. If using an 11.1v nunchuk-type lithium battery, insert the longer end **(D)** down the center and set the shorter end **(E)** at the rear.

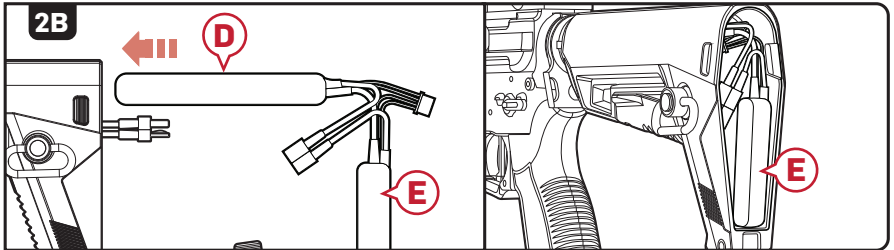

WARNING

EXCESSIVE PULLING OR TUGGING OF THE BATTERY WIRES WHEN INSERTING OR REMOVING THE BATTERY CAN CAUSE THE FUSE HOUSING TO COME LOOSE OR DAMAGE TO THE GUN.

3. Neatly arrange the wires, then pivot the cover upwards to close. Be sure that the cover latches do not catch on the wires and that the wires are not pinched by the cover.

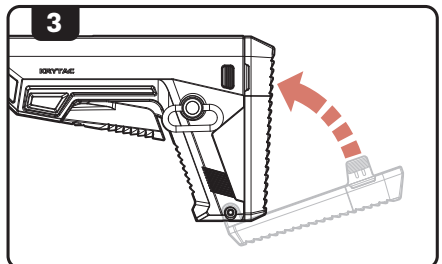

BATTERY INSTALLATION

LMG-MP

1. Turn the handguard retaining nut (A) to loosen the lower handguard (B).
2. Lift the front (C) of the lower handguard and then pull the lower handguard forward and away to remove.

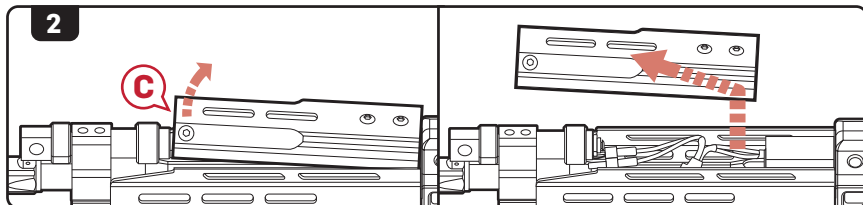
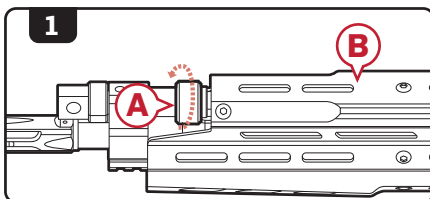

3. Connect the battery (D) and place it inside the handguard (E).

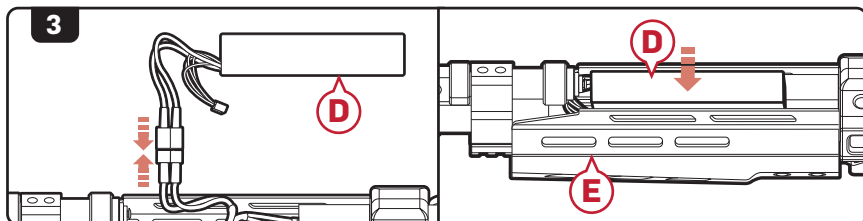

4. Replace the lower handguard back into position and tighten the handguard retaining nut to secure into place.

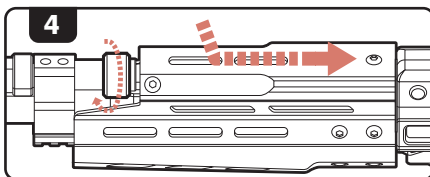

TRIGGER PULL ADJUSTMENT

NOTE Before adjusting the trigger pull, set the fire select to SAFE, remove the magazine and disconnect the battery.

1. Use a 1.5mm Allen wrench to adjust the trigger pull length.
Turn clockwise to shorten the pull.
Turn counter-clockwise to lengthen the pull.

WARNING TAKE CARE NOT TO OVER TORQUE THE ADJUSTMENT SCREW.

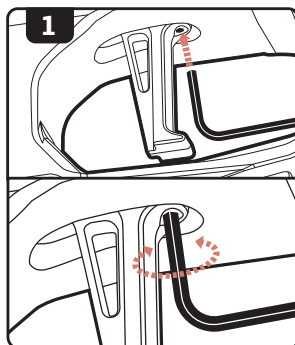

HOP-UP SYSTEM

The advanced KRYTAC rotary hop-up unit is a standard feature in the Trident series AEGs. Proper adjustment of the hop-up will allow the AEGs to fire in a variety of shooting environments to obtain optimal BB trajectory.

Hop-Up Adjustment

1. Pull the charging handle (A) downward then rearward. Hold charging handle in position to access the hop-up adjustment dial (B).

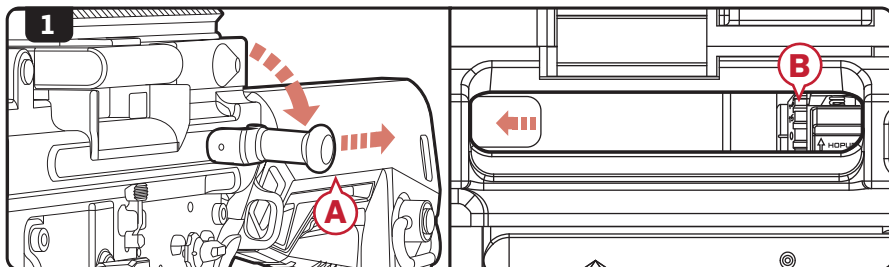

2. Turn the dial up or down, an audible click will confirm each adjustment.

Increasing the number on the dial will increase the amount of hop-up on the BB. Decreasing the number will lower the amount of hop-up on the BB.

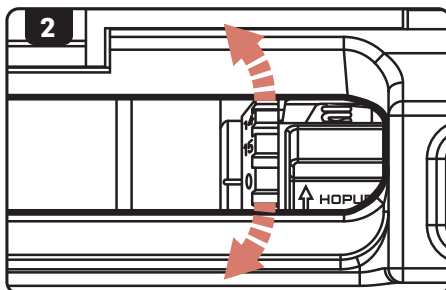

Excessive Hop-Up

Airsoft BB travels in an extreme upward trajectory. Decrease the hop-up.

Ideal Hop-Up

Airsoft BB travels in a long, horizontal flight path.

Insufficient Hop-Up

Airsoft BB travels a short distance in a downward trajectory. Increase the hop-up.

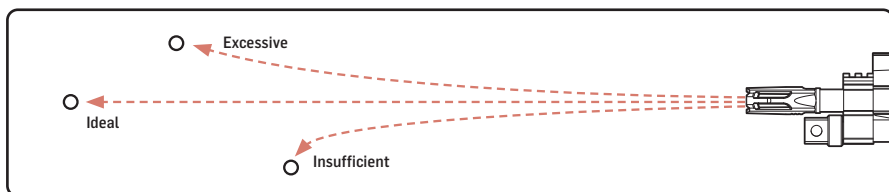

CLEARING JAMMED BBS

1. Disassemble the airsoft gun and remove the inner barrel assembly **(A)**. (see pg.14 for disassembly instruction).
2. Lift the Hop-up lever **(B)** from the inner barrel assembly (refer to step 3 of pg.19).
3. Take the cleaning rod **(C)** and insert the unjamming side from the front of the barrel through to the rear to clear out the jammed BB.

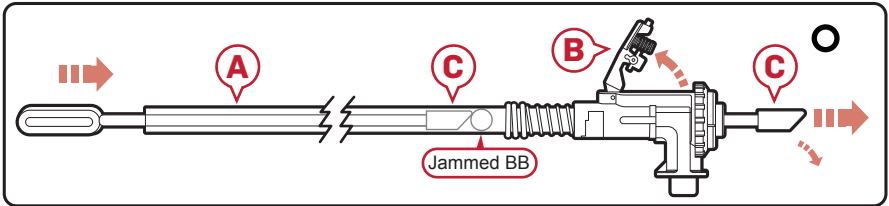

4. Look through the barrel to ensure that it is cleared.
5. Reassemble the airsoft gun. (see pg.15 for assembly instruction).

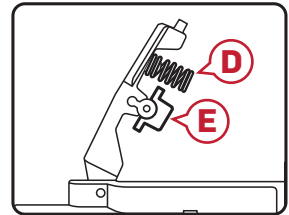

WARNING TAKE CARE NOT TO LOSE THE TENSION SPRING **(D)** AND THE SPACER NUB **(E)**.

NOTE Use only new, quality airsoft BBs. Never use recycled or low quality airsoft BBs, doing so may cause jamming or poor performance. In most cases, it can severely damage the internal gearbox and/or hop-up and inner barrel.

DISASSEMBLY

NOTE Before opening up the receiver, remove the magazine and fire the airsoft gun in a safe direction to ensure that the hop-up chamber is clear of any BBs.

1. Set the AEG to safe mode.
- 2A. **LMG-M**: Remove the stock cover and disconnect the battery.
- 2B. **LMG-MP**: Remove the lower handguard and disconnect the battery.

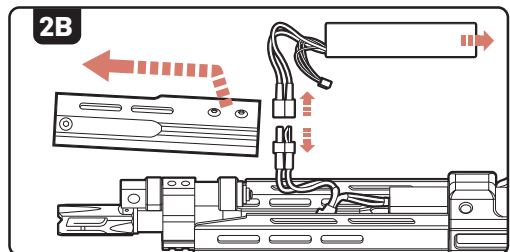
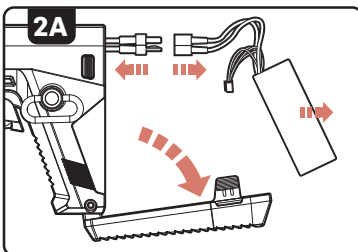

DISASSEMBLY

3. Remove **ONLY** the front pin **(A)** from the receiver.
4. Completely separate the upper and lower receiver.
5. Slide the hop-up and inner barrel assembly **(B)** out of the upper receiver.

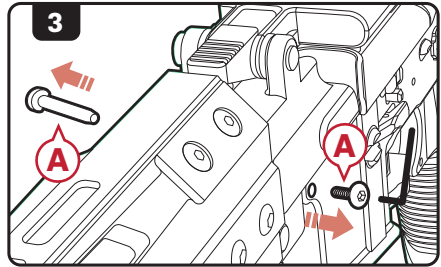

NOTE KEEP TRACK OF THE HOP-UP TENSION SPRING **(C)** SO IT DOES NOT BECAME LOST DURING DISASSEMBLY.

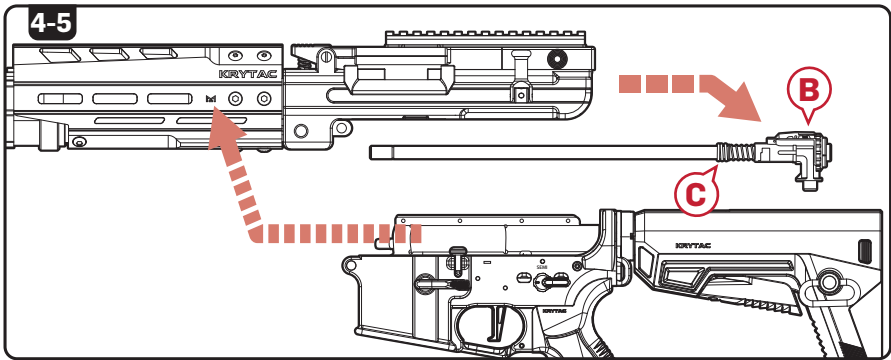

ASSEMBLY

1. Insert the hop-up and inner barrel assembly into the upper receiver. Make sure to line up the hop-up to the receiver.
2. Carefully slide the upper receiver back onto the lower receiver.
3. Reinstall and secure the front body pin.

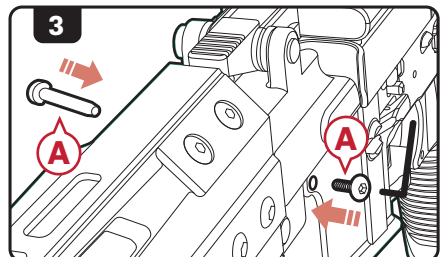
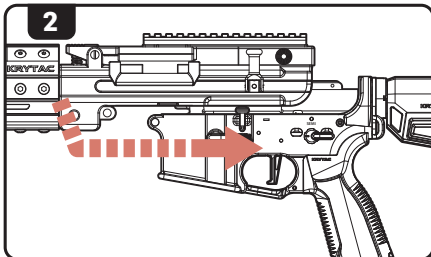
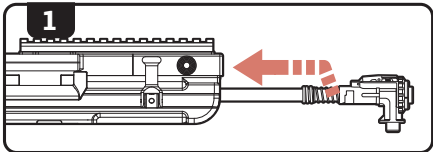

MAIN SPRING ACCESS



WARNING

PLEASE REVIEW THE WARRANTY CARD INFORMATION BEFORE OPENING AND/OR MODIFYING THE KRYTAC AIRSOFT GUN.

1. Disassemble the airsoft gun. (see pg.14 for disassembly instruction).
2. Pull down on the tab of the stock adjustment lever **(A)**, slide the stock **(B)** rearward and off the buffer tube **(C)**.
3. Use a Phillips (P2) screw driver to remove screw **(D)** and washer **(E)** from inside the buffer tube **(C)**.
4. Remove the buffer tube **(C)**.
5. Remove the sling plate **(F)**.

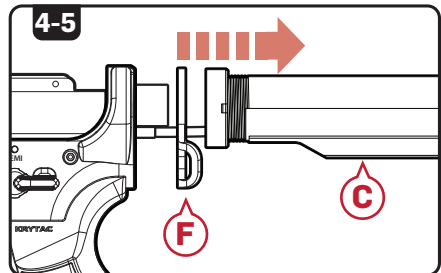
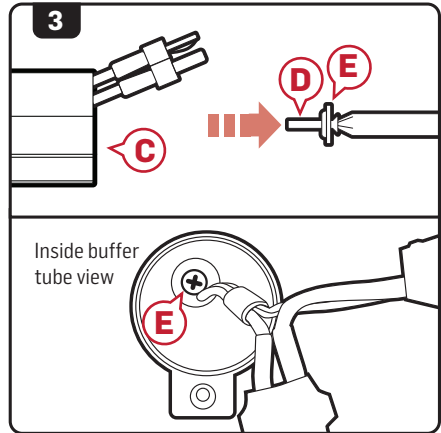
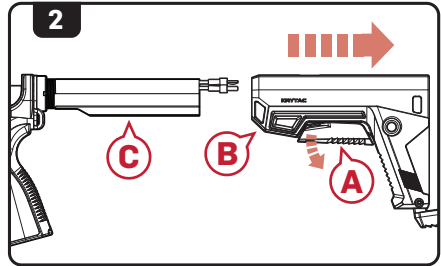

MAIN SPRING ACCESS

6. Remove the screws **G** from the magazine release button **H** using a Phillips (P1) screw driver, then remove the magazine release button **H**.
7. Use a 2.5 mm hex key to remove the rear receiver pin screw **I**.
8. Use a 2 mm hex key to remove 2 screws **J** on the bottom of the motor plate **K** then remove the motor plate.
9. Disconnect the motor wires **L** and remove the motor **M**.

NOTE

Take note of the wire and motor orientation before disconnecting.

10. Remove 2 Phillips (P2) screws **N** at the top of the motor grip interior, then remove the motor grip **O**.

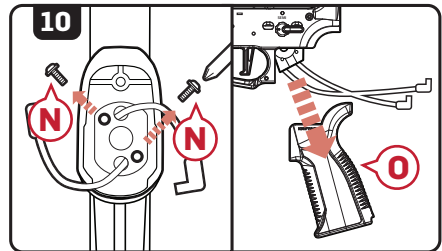
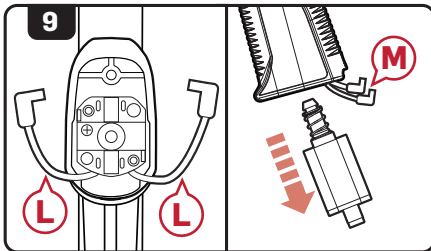
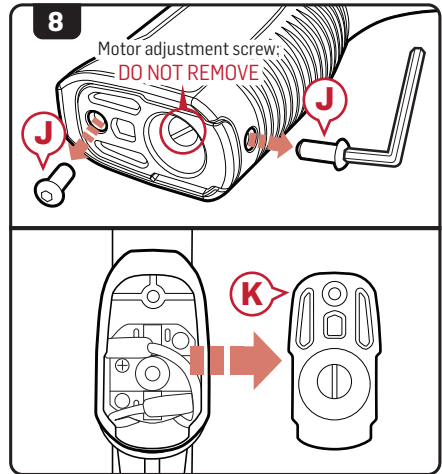
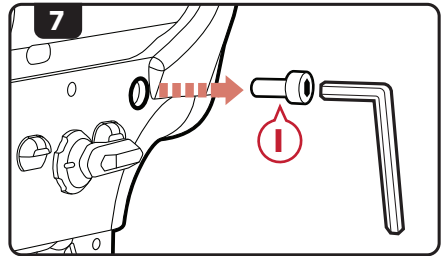
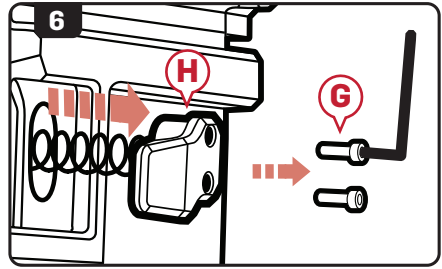

MAIN SPRING ACCESS

11. Remove the right side selector switch **P** using a 2 mm hex key.
12. Press the rear receiver pin **Q** in and remove it from the other side of the airsoft gun.
13. Use a 2.5 mm punch **R** and press the trigger pin **S** in and remove it from the other side of the airsoft gun.
14. Move the selector switch **T** half way between safe mode and semi-automatic mode then slide the gearbox **U** out of the lower receiver.
15. Use an flathead screwdriver **V**, push the anchored spring guide **W** into the gearbox, turn 90° clockwise then pull the spring guide and spring **X** out.

NOTE

Spring guide is under extreme pressure. Remove with caution.

16. Re-insert the anchored spring guide with desired spring into gear box. Follow steps in reverse order to reassemble the airsoft gun.

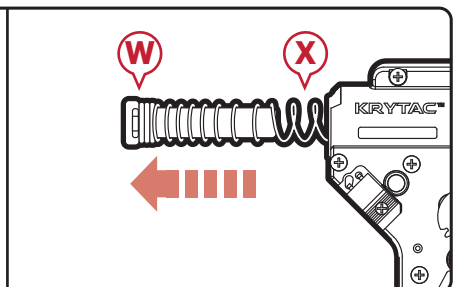
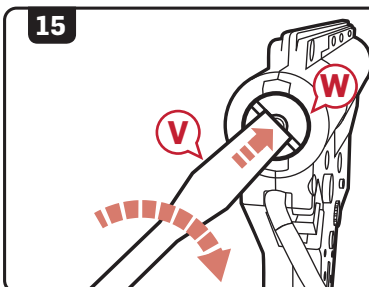
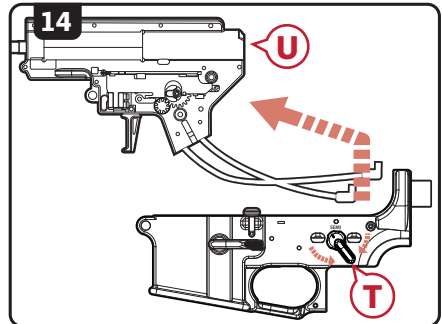
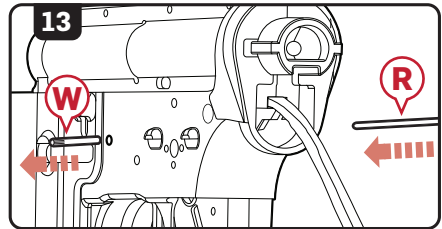
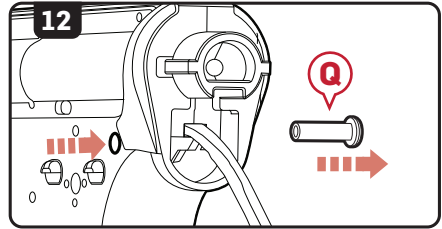
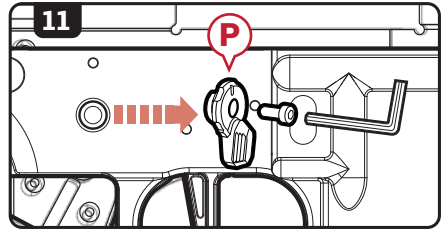

CLEANING AND MAINTENANCE

NOTE

WHILE POINTING THE AIRSOFT GUN IN A SAFE DIRECTION, REMOVE THE MAGAZINE AND CYCLE THE GEARBOX UNTIL NO BBS EXIT THE INNER BARREL. PLACE THE AIRSOFT GUN IN SAFE MODE AND DISCONNECT THE BATTERY PRIOR TO ANY CLEANING PROCEDURES.

1. Wipe down the external parts of the gun and remove any dirt and debris.
2. Disassemble the airsoft gun as described in the Disassembly section and pull out the barrel and hop-up assembly (A).
3. Pull back on the hop-up adjustment wheel (B) and lift the hop-up adjustment lever (C) up.
4. Take a lint-free cleaning patch (D) and place it through the looped end of the cleaning rod (E).

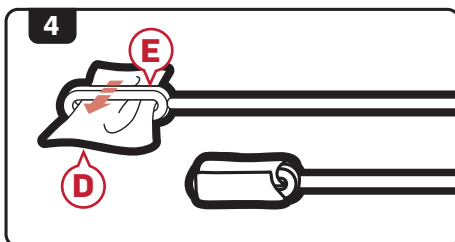
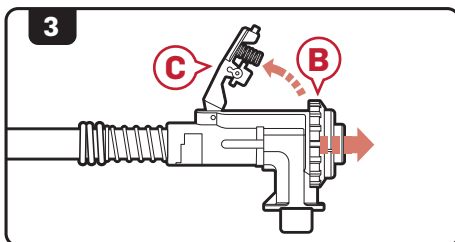
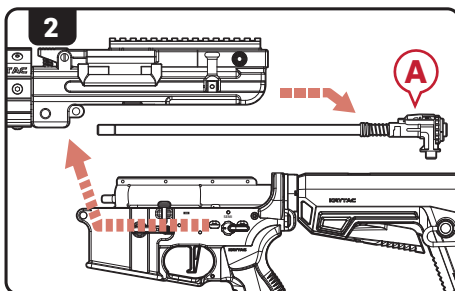
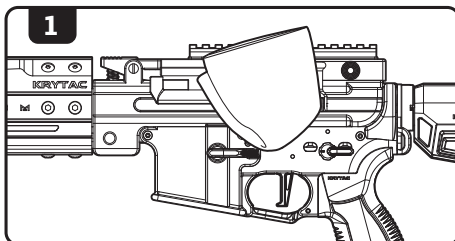

WARNING

DO NOT ADD OIL TO THE HOP-UP BUCKING. EXCESSIVE OIL ON THE HOP-UP BUCKING MAY NEGATE THE HOP-UP, DECREASING RANGE AND ACCURACY.

CLEANING AND MAINTENANCE

5. Run the cleaning rod through the barrel from back to front (in the same direction that BBs travel).

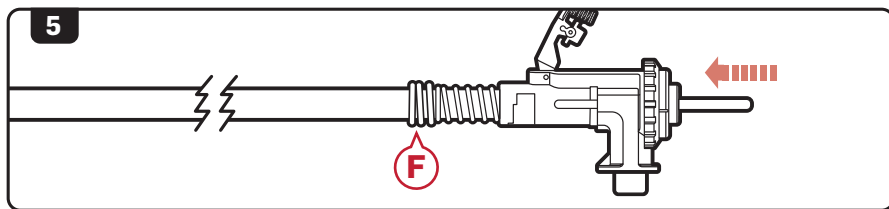

KEEP TRACK OF THE BARREL SPRING (F), IT CAN SEPARATE FROM THE BARREL ASSEMBLY.

6. Pull back on the hop-up adjustment wheel and lower the hop-up adjustment lever back into position.
7. Reinsert the hop-up barrel assembly into the receiver and reassemble as described in the Assembly section.

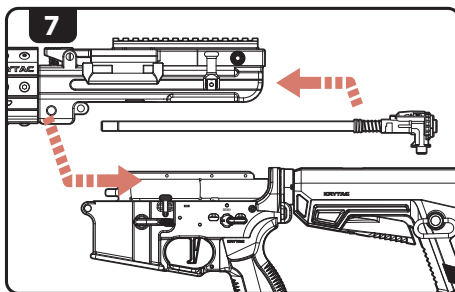
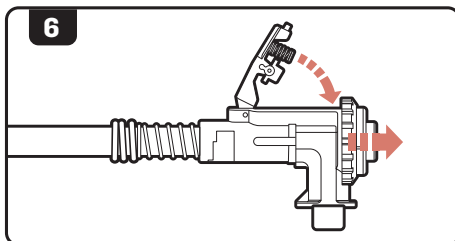

TROUBLE SHOOTING GUIDE



WARNING

WHEN TROUBLESHOOTING, FOLLOW THE SAFETY MEASURES DESCRIBED IN THIS MANUAL.

SYMPTOMS	CAUSE	SOLUTIONS
Not firing/No sound	Safety is engaged	Change selector to Semi Auto or Full Automatic Mode
	Low power or dead battery	Charge and replace battery
	Blown out fuse	Replace with new fuse
	Loose connection	Contact customer service for professional care
Motor is running but not firing	Inspect magazine	Check if magazine is properly loaded into the gun Ensure magazine is loaded with ammunition Ensure the hi-cap magazine is properly wound
Motor or battery is hot after short use	Damaged battery	Inspect and/or replace battery
	Loose connection terminal	Contact customer service for professional care
Semi-Auto feature not functioning properly	Battery voltage or discharge is too high	Condition or replace battery
Semi-Auto feature not working at all	Disconnecter is not engaged properly	Reset the disconnecter by setting the selector to safe, then to automatic, then to semi
Firing cycle slowing down	Battery is low on power	Charge or replace battery
High pitch or grinding noise	Motor level is not adjusted properly	Contact customer service for professional care
BB travels upward	Hop-up adjusted too high	Dial down the hop-up adjustment
BB travels downward	Hop-up adjusted too low	Dial up the hop-up adjustment
BB double feeding or rolling out of the barrel	Excessive grease or oil in the hopup chamber	Fire at least 200 rounds to eliminate excessive grease from the chamber Clean hop-up unit with supplied cleaning rod
	Hop-up unit is turned off	Turn hop-up unit on
Hop-up unit can't be adjusted	Hop-up adjustment arm is not set properly	Reset hop-up adjustment arm (See page 20, step 6 for reassembly)
Inner barrel is jammed or jamming	Use of recycled or low quality BBs	Use only KRYTAC branded or other high quality BBs
	Inner Barrel is contaminated with BBs or debris	Clean and/or clean inner barrel with supplied cleaning rod (See page 13 for clearing jam section and page 19 for cleaning and maintenance section)
Hi-Cap magazine not feeding	Magazine has not been wound	Wind wheel underneath magazine
	BBs are lodged inside the magazine	Shake or tap magazine to clear the jam
	Internal obstruction	Contact customer service for professional care

OPERATING UNDER HARSH CONDITIONS

When operating under harsh conditions, special maintenance may be required to match the climate conditions of a specific operational area.

Dust and Sand

In harsh dusty or sandy environments, excessive debris can cause malfunctions and/or excessive wear on parts. Keep the gun covered and protected while not in use. When performing maintenance, use lubrication sparingly as it tends to attract dirt and other particles. After use in a dusty or sandy area, always field strip the gun, as outlined in the Disassembly section, cleaning all the areas that can be reached with a soft, clean, lint-free cloth.

Heavy Rain

Never submerge or expose your gun to extremely wet environments. Exposure to such conditions may cause electrical failure and fluid to build-up inside the gearbox. Dry completely with a clean, lint-free cloth and clean inner barrel when necessary.

HEARING PROTECTION REQUIREMENT

HEARING PROTECTION REQUIREMENT FOR EUROPEAN COMMUNITY

The KRYTAC TRIDENT LMG-M, LMG-MP fulfill all relevant provisions of:

EMC Directive (2014/30/EU)
RoHS Directive (2011/65/EU)
General Product Safety Directive (2001/95/EC)

In conjunction with the following harmonized standards or technical specifications for the design and manufacture

EN 50581:2012; EN 55014-1:2006; EN 55014-2:1997

In accordance with the above mentioned standards, in some applications, noise or vibration levels may exceed the minimum Noise levels of 85db(A). If Noise levels exceed 85dB(A), appropriate ear protection must be used to prevent any damages due to sound emissions.

CONTACT INFORMATION

For additional troubleshooting, information, or questions regarding KRYTAC customer service:

Submit a contact form at: www.krytac.com

Email us at: support@krytac.com

Visit the KRYTAC Help Desk at <https://support.krytac.com> for additional technical information and guides.

COMPONENT DIAGRAM: LMG-M, LMG-MP

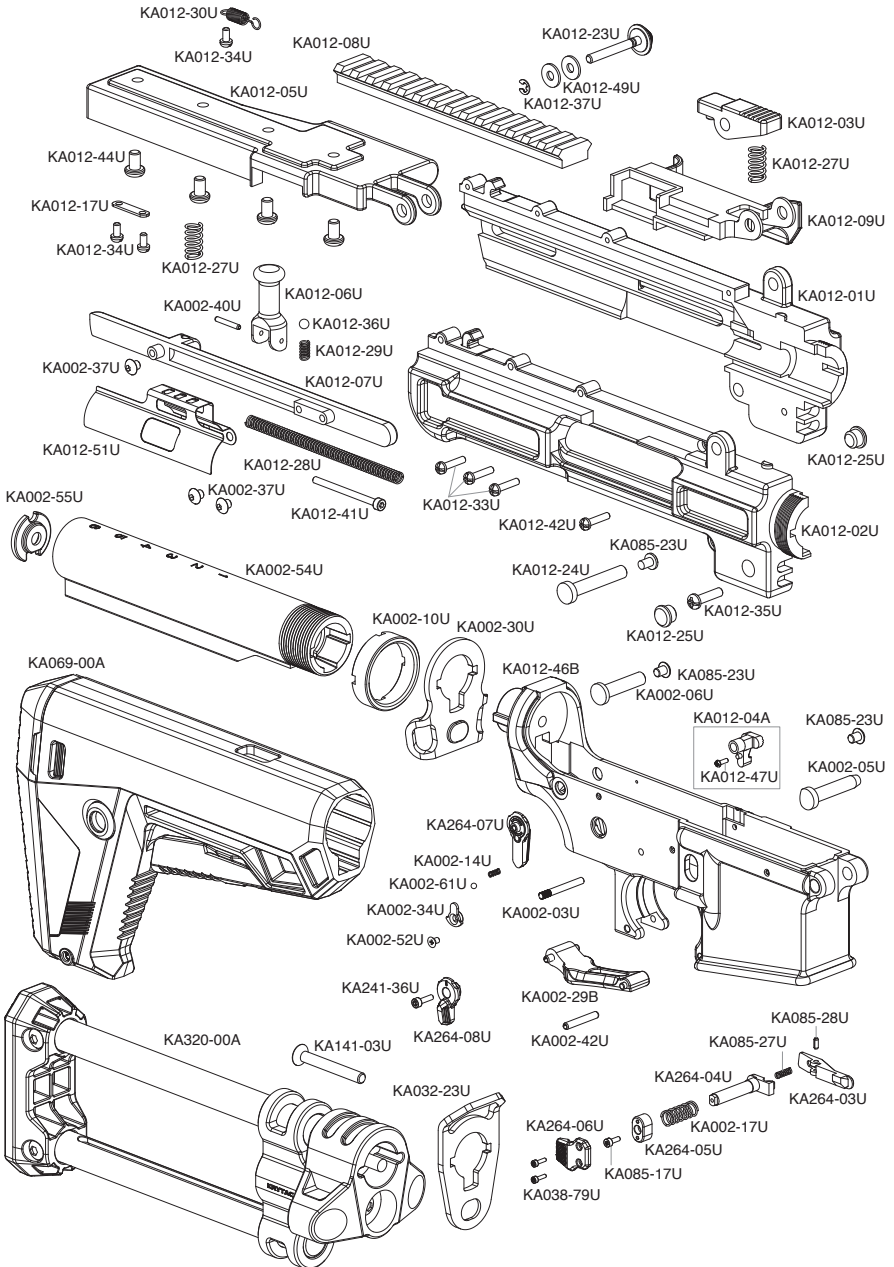

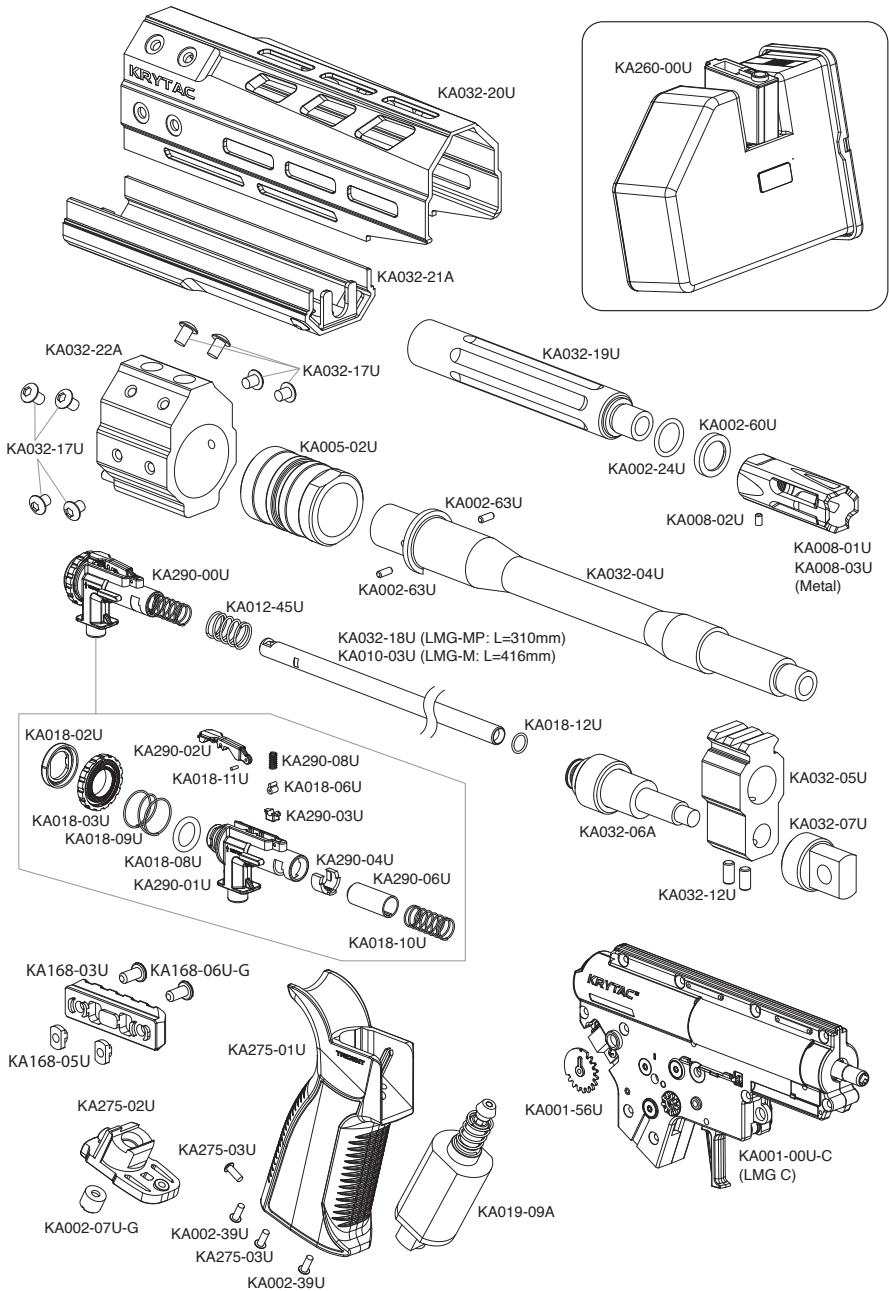

COMPONENT DIAGRAM: GEARBOX

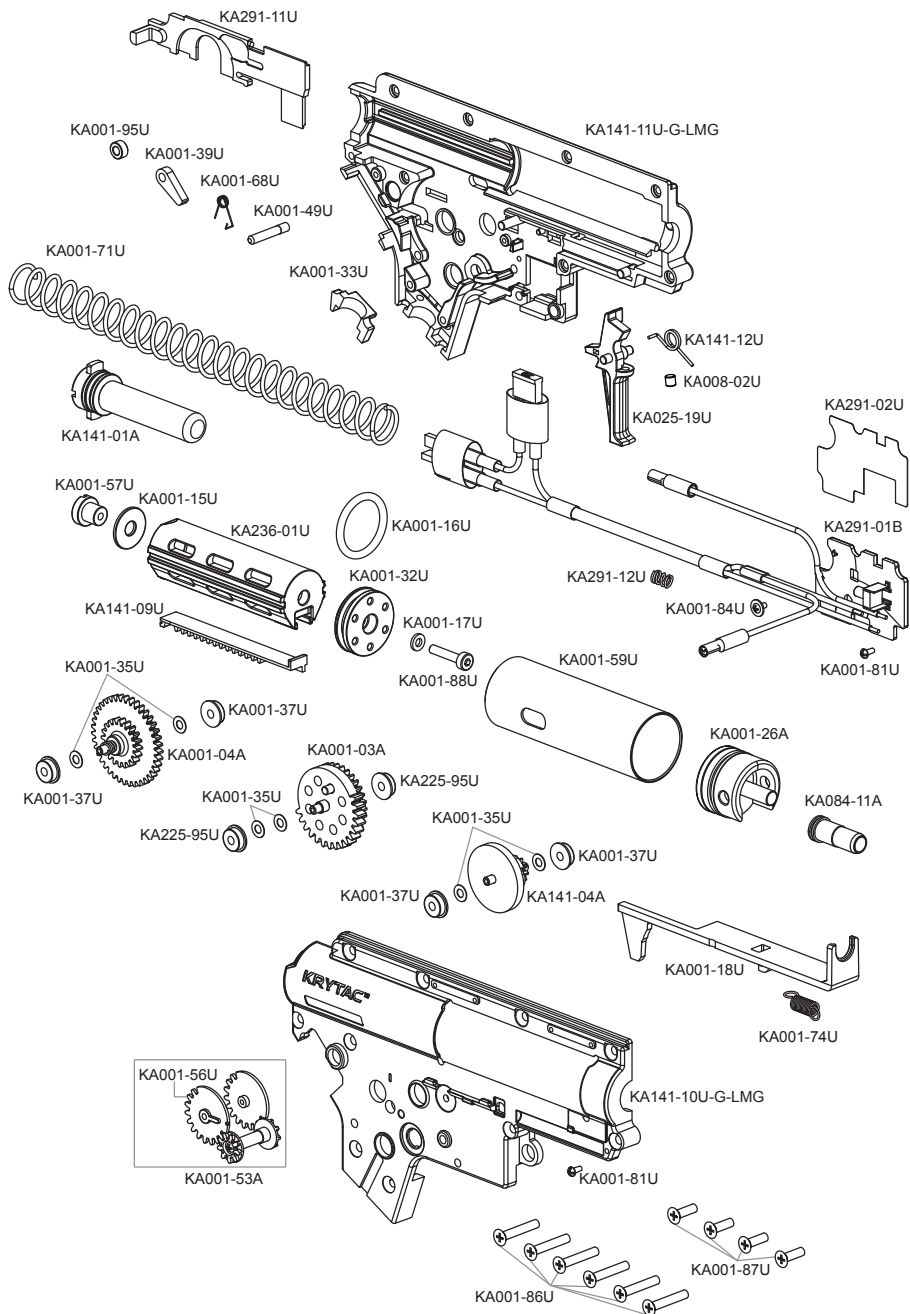

COMPONENT LIST: LMG-M, LMG-MP

PART #	NAME		
KA001-00U-C	GEARBOX	KA008-03U	FLASH HIDER (METAL)
KA001-03A	SECTOR GEAR	KA010-03U	INNER BARREL (LMG-M: 416 MM)
KA001-04A	SPUR GEAR	KA012-01U	LMG UPPER HALF (LEFT)
KA001-15U	MAIN SPRING SHIM	KA012-02U	LMG UPPER HALF (RIGHT)
KA001-16U	PISTON HEAD O-RING	KA012-03U	MOCK RELEASE LEVER
KA001-17U	PISTON HEAD SHIM	KA012-04A	LMG BOLT RELEASE
KA001-18U	TAPPET PLATE	KA012-05U	LMG DUST COVER
KA001-26A	CYLINDER HEAD ASSEMBLY	KA012-06U	LMG CHARGING HANDLE
KA001-32U	PISTON HEAD	KA012-07U	CHARGING SLIDE
KA001-33U	WIRING COVER	KA012-08U	LMG DUST COVER RAIL
KA001-35U	SHIM (6)	KA012-09U	LMG FEED TRAY
KA001-37U	BEARING (4)	KA012-17U	DUST COVER RELEASE PLATE
KA001-39U	ANTI-REVERSE LATCH	KA012-23U	DUST COVER RELEASE
KA001-49U	ANTI-REVERSE LATCH PIN	KA012-24U	LMG DUST COVER PIN
KA001-53A	SELECTOR GEAR ASSEMBLY	KA012-25U	LMG UPPER CROSSBOLT CAP (2)
KA001-56U	SELECTOR GEAR (RIGHT)	KA012-27U	LMG DUST COVER SPRING (2)
KA001-57U	PISTON HEAD NUT	KA012-28U	CHARGING SLIDE SPRING
KA001-59U	CYLINDER (TYPE 1)	KA012-29U	CHARGING HANDLE SPRING
KA001-68U	ANTI-REVERSE LATCH SPRING	KA012-30U	DUST COVER RELEASE SPRING
KA001-71U	MAIN SPRING	KA012-33U	RECEIVER PANEL TOP SCREWS (3)
KA001-74U	TAPPET PLATE SPRING	KA012-34U	DUST COVER RELEASE SCREWS
KA001-81U	BUTTON MICRO SCREW (2)	KA012-35U	RECEIVER PANEL CROSSBOLT SCREW
KA001-84U	FLAT MICRO SCREW	KA012-36U	CHARGING HANDLE DETENT BALL
KA001-86U	GEARBOX SHELL SCREW (LONG)(6)	KA012-37U	DUST COVER RELEASE CLIP
KA001-87U	GEARBOX SHELL SCREW (SHORT)(4)	KA012-41U	CHARGING SPRING GUIDE
KA001-88U	PISTON HEAD SCREW	KA012-42U	RECEIVER PANEL SHORT SCREW
KA001-95U	ANTI-RELEASE LATCH BUSHING	KA012-44U	DUST COVER SCREWS
KA002-03U	GEARBOX PIN	KA012-45U	HOP-UP TENSION SPRING
KA002-05U	FRONT RECEIVER PIN	KA012-46B	RECEIVER
KA002-06U	REAR RECEIVER PIN	KA012-47U	BOLT RELEASE SCREW
KA002-07U-G	MOTOR SCREW	KA012-49U	DUST COVER RELEASE WASHER
KA002-10U	CASTLE NUT	KA012-51U	MOCK BOLT COVER
KA002-14U	SELECTOR DETENT SPRING	KA018-02U	ADJUSTMENT CAP
KA002-17U	MAGAZINE RELEASE SPRING	KA018-03U	ADJUSTMENT WHEEL
KA002-24U	CRUSH WASHER O-RING	KA018-06U	NUB
KA002-29B	TRIGGER GUARD ASSEMBLY	KA018-08U	ADJUSTMENT RETENTION O-RING
KA002-30U	SLING PLATE	KA018-09U	ADJUSTMENT SPRING
KA002-34U	SELECTOR LEVER	KA018-10U	TENSION SPRING
KA002-39U	BUTTON SOCKET CAP SCREW (2)	KA018-11U	ADJUSTMENT LEVEL PIN
KA002-40U	CHARGING HANDLE PIN	KA018-12U	FRONT BARREL O-RING
KA002-42U	TRIGGER GUARD PIN	KA019-09A	MOTOR
KA002-52U	SELECTOR SCREW (LEFT)	KA025-19U	TRIGGER
KA002-54U	BUFFER TUBE	KA032-04U	LMG-M OUTER BARREL (16")
KA002-55U	BUFFER TUBE SCREW CAP	KA032-05U	GAS BLOCK
KA002-60U	CRUSH WASHER	KA032-06A	GAS ROD
KA002-61U	SELECTOR BALL	KA032-07U	GAS NUT
KA002-63U	BARREL BASE PIN (2)	KA032-12U	GAS BLOCK SCREWS (2)
KA005-02U	BARREL NUT	KA032-17U	HANDGUARD SCREWS (8)
KA008-01U	FLASH HIDER (ORANGE PLASTIC)	KA032-18U	INNER BARREL (LMG-MP: 310 MM)
KA008-02U	SET SCREW	KA032-19U	LMG-MP OUTER BARREL (9")
		KA032-20U	LMG M-LOK UPPER HANDGUARD
		KA032-21A	LMG M-LOK LOWER HANDGUARD
		KA032-22A	HANDGUARD SPACER
		KA032-23U	BUTTSTOCK SLING PLATE
		KA038-79U	MAGAZINE CATCH SCREW (2)
		KA069-00A	SLIM BATTERY STOCK
		KA084-11A	AIR NOZZLE
		KA085-17U	MAGAZINE RELEASE BUTTON SCREW
		KA085-23U	RECEIVER PIN CAP SCREW (2)
		KA085-27U	MAGAZINE RELEASE LEVER SPRING
		KA085-28U	MAGAZINE RELEASE PIN
		KA141-01A	SPRING GUIDE ASSEMBLY
		KA141-03U	BUFFER TUBE SCREW
		KA141-04A	BEVEL GEAR
		KA141-09U	PISTON TOOTH RACK
		KA141-10U-G-LMG	GEARBOX SHELL (RIGHT)
		KA141-11U-G-LMG	GEARBOX SHELL (LEFT)
		KA141-12U	TRIGGER SPRING
		KA168-03U	M-LOK SIDE RAIL (MEDIUM)
		KA168-05U	SLIDE RAIL NUT (2)
		KA168-06U-G	SIDE RAIL SCREW (2)
		KA225-95U	BEARING (2)
		KA236-01U	PISTON BODY
		KA241-36U	SOCKET HEAD CAP SCREW M2.5*6
		KA260-00U	BOX MAGAZINE
		KA264-02U	BOLT CATCH ENLARGED
		KA264-03U	AMBI MAGAZINE CATCH
		KA264-04U	AMBI MAGAZINE CATCH BODY
		KA264-05U	AMBI MAGAZINE CATCH BUTTON
		KA264-06U	AMBI MAGAZINE CATCH EXTENDED BUTTON
		KA264-07U	FIRE SELECTOR G2 (LEFT)
		KA264-08U	FIRE SELECTOR G2 (RIGHT)
		KA275-01U	KRYTAC GRIP GEN2
		KA275-02U	GEN 2 MOTOR PLATE ASSEMBLY
		KA275-03U	PISTOL GRIP SCREW
		KA290-00U	GEN 2 HOP-UP ASSEMBLY
		KA290-01U	GEN 2 HOP-UP MAIN BODY
		KA290-02U	GEN 2 HOP-UP ARM
		KA290-03U	GEN 2 HOP-UP SPACER NUB
		KA290-04U	GEN 2 HOP-UP BARREL CLIP
		KA290-06U	GEN 2 HOP-UP BUCKING
		KA290-08U	GEN 2 HOP-UP ARM SPRING
		KA291-01B	ELECTRONIC CONTROL UNIT AND WIRING ASSEMBLY
		KA291-02U	INSULATING-SHEET
		KA291-11U	SELECTOR PLATE FOR ECU
		KA291-12U	MICROSWITCH TRIGGER SPRING
		KA320-00A	LMG-MP STOCK ASSEMBLY

www.krytac.com

© Copyright 2024
KRISS INDUSTRIES ASIA
Subject to change

V.02_2024.11.07

